



INSTALLATION INSTRUCTIONS

TRAILER HITCH RECEPTACLE and
WIRING HARNESS
For 1980-1996 FLT, FLHT, FLHR, FLST w/KW HITCH
Mfg. p/n 720560, 720557A
(See pkg. label for Dist. p/n)

ATTENTION INSTALLER (if other than owner):

Please forward this instruction sheet and the warranty card to the purchaser of this product. These instructions also contain valuable information necessary to the end user.

INTRODUCTION:

These instructions describe the procedure for properly installing KHROME WERKS® Trailer Hitch Receptacle and wiring harness on 1980-1996 FLT, FLHT, FLHR or FLST models equipped with the new style Khrome Werks Trailer Hitches featuring welded tabs for receptacle bracket mounting or with the optional ball mount bracket which incorporates safety chain slots and 5 pin receptacle mount. Review instructions carefully before beginning, as they contain important information. Please retain for future reference.

Particularly important information is distinguished in these instructions by the following notations:

NOTE: A NOTE provides key information to make procedures easier or clearer.

CAUTION: A CAUTION indicates special procedures that must be followed to avoid damage to the motorcycle or accessories.

WARNING: A WARNING indicates special procedures that must be followed to avoid injury or death to a motorcycle operator or person inspecting or repairing the motorcycle.

All Models:

CAUTION: If you have a trailer that has automotive combination tail, stop and turn signal lights (four wire system) you will need a 5 wire to 4 wire convertor. Follow the instructions with the convertor. An option is to add additional lights to the trailer so the turn signals and brake lights are separated.

CAUTION: Do not use with more than two tail/stop lights and two turn signals). A separate fused circuit utilizing a trailer isolation relay device must be installed if more lights are used to avoid overloading the main fused lighting circuit.

TOOLS REQUIRED:

- | | |
|-----------------------------|----------------------------------|
| 1 . #2 Phillips screwdriver | 1 . 3/8+combination wrench |
| 1 . wire stripper | 1 . wire connector crimper |
| 1 . side cutter | 1 . 5/32+flat blade screw driver |

Supplies: Silicone sealer

PROCEDURE:

1. Remove seat and or side covers

WARNING: Disconnect battery cable (negative cable first) to prevent short circuits before performing following procedures.

2. Create a wiring plan to connect the new wiring harness to the motorcycles electrical system.

NOTE: Typical Harley wire colors.

Blue: connects to taillight circuit.

Red: connects to right brake light circuit.

Brown: connects to right turn signal circuit.

Purple: connects to left turn signal circuit.

Black wire connects to a good ground.

3. Determine a starting point for the harness (under the seat or side cover). We suggest connecting the blue taillight wire to the motorcycles lighting circuit breaker using the number 10 ring terminal. The black ground wire can be connected to the battery ground terminal with the 5/16+ring terminal. Use the Scotchloks to splice the remaining harness wires to the appropriate motorcycle circuits.

4. Install the 5 pin receptacle and bracket included in kit 720560 to the bottom of the hitch safety chain bracket or to the %Under the ball Bracket+included in kit 720557A with the supplied screws and nuts (ref items 1-4). Do not tighten.

5. Connect the wiring harness to the motorcycle's electrical system per your plan. Carefully route the wiring harness from the starting point to the 5 pin receptacle following the frame/fender struts insuring that no contact is possible with the exhaust, rear wheel, brake rotor/ caliper, shocks and drive chain or belt. Use the supplied tie wraps to secure in place.

6. Cut the wires and housing to the right length after determining satisfactory routing to the receptacle bracket. Remove the receptacle and bracket from the hitch. Loosen the external set screw and remove the male pin plug inside the receptacle. Note the index of the plug to the housing (It may not match the provided sketch). **CAUTION:** Make sure the receptacle's internal plastic sleeve remains in place to insure that the connected wires do not directly contact the metal housing.

NOTE: If using the %Under the Ball+mounting bracket thread the housing and wires through the back side of receptacle tab on the brackets right side and then through the receptacle housing before connecting wires. The %Safety Chain+model receptacle bracket is slotted and can be installed later.

CAUTION: We have provided a suggested connection diagram to insure that the wire connections are correct (Ref 6). However, it's not important where each wire goes, only that both connectors are wired the same (taillight wire from the motorcycle is wired to the receptacle pin that connects to the pin housing in the trailer connector (ref 5) which routes to its taillights). The trailer's wires may be different colors as there is no industry standard, so test each color wire and develop a diagram. If your trailer is already wired with a 5 pin plug make sure it is physically compatible with the supplied receptacle connector and the wiring indexing of the motorcycles connector plug.

KHROME WERKS®

P.O. BOX 355 • New Prague, MN 56071

INSTALLATION INSTRUCTIONS

TRAILER HITCH RECEPTACLE and
WIRING HARNESS
For 1980-1996 FLT, FLHT, FLHR, FLST w/KW HITCH
Mfg. p/n 720560, 720557A
(See pkg. label for Dist. p/n)

7. Strip the wire insulation (short as possible) and connect to the plug. Red wire is stop light, Blue is taillight, Black is ground, Brown is right signal, Purple is left turn signal. Index and insert the plug into the receptacle housing and install the set screw. Seal the back of the plug with silicone. Reinstall the assembled receptacle and bracket to the hitch.

8. Repeat the procedure to wire the trailer plug (Ref 5). Insure that the trailer's wiring harness is long enough to allow the tightest turn possible.

9. Lubricate ball and connect trailer, close and secure coupler lever with safety pin or lock. Connect safety chains and test lights. Torque all mounting hardware after first usage.

10. Install saddlebags and the seat and side covers.

BILL OF MATERIALS

Mfg. p/n	Description	720560	720557A
720561	Wire harness	1	1
1890061	Wire terminal #10, 16-22	1	1
189021	Wire terminal 5/16+, 18-22	1	1
1931001	Cable ties, 7.5+black	6	6
3052011	Scotchlok connector	8	8
420102	Nut, 10-32 kep	4	4
424124	Screw, phil 10-32 x 1/2+	2	2
680793A	Connector plate w/studs	1	
7205571	Ball mount connector bracket		1
708132	5-pin male/female connector	1	1

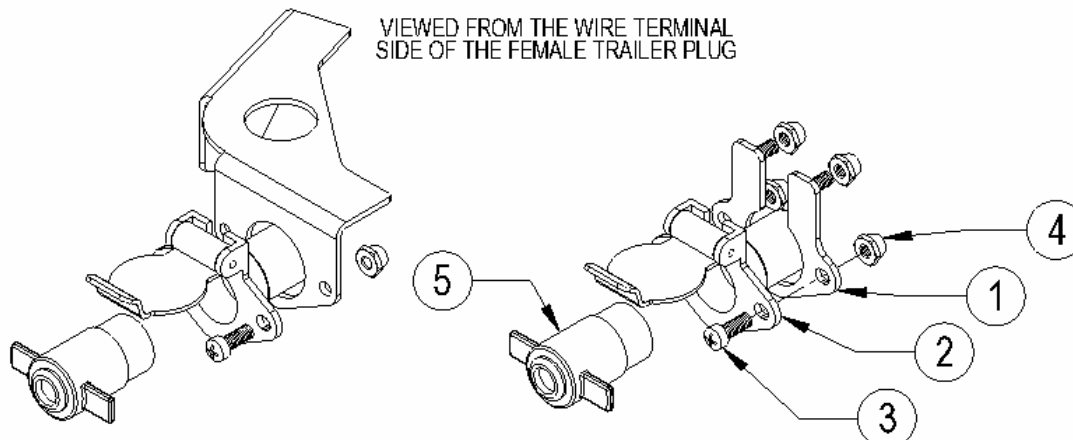
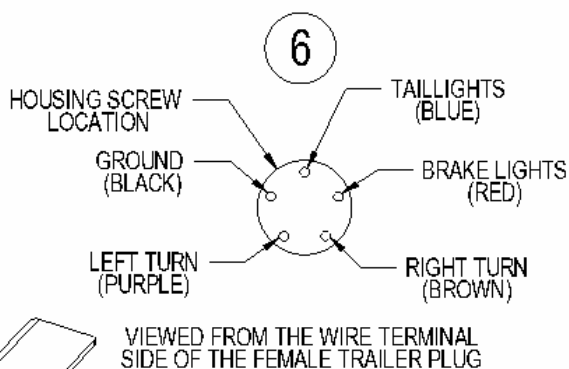
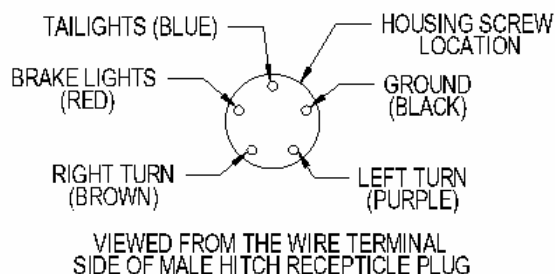

KHROME WERKS®
P.O. BOX 355 • New Prague, MN 56071